

# Coaxial Surge Protectors - 4GHz

## P8AX Series



P8AX09-N/MF

- **4GHz Bi-Directional Coaxial Surge Protector**
- **High Energy GDT Technology**
- **Low Insertion Loss**
- **Field Replaceable GDT**
- **Waterproof Design**
- **DC Pass Configuration**
- **UL497E Listed**

P8AX- - -

Type : MF = Male/Female  
FF = Female/Female

Connectors (see reference system page 112)

Voltage (see reference system page 112)

## Dimensions and Electrical Diagram

(in mm)

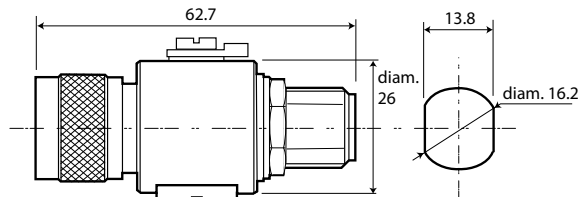

Dimensions vary by connector, N connector shown

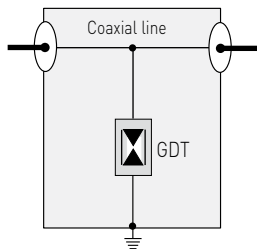

GDT: 2-electrode gas discharge tube

## Characteristics

CITEL Part Number	P8AX09	P8AX25	P8AX50
Frequency range	DC-4GHz <sup>1</sup>	DC-4GHz <sup>1</sup>	DC-4GHz
Technology	GDT	GDT	GDT
Insertion loss	≤0.2db	≤0.2db	≤0.2db
Return Loss	≥20 db	≥20 db	≥20 db
VSWR	<1.2:1	<1.2:1	<1.2:1
Discharge Current (8/20 μs)	20 kA	20 kA	20 kA
Protection Level	<600 V	<600 V	<1000 V
Maximum Power	25 W	190 W	780 W
Maximum Current	10 A	10 A	10 A
Impedance	50 ohms <sup>2</sup>	50 ohms <sup>2</sup>	50 ohms <sup>2</sup>
Connection Method	Series (bi-directional)		
Mechanical characteristics			
Connectors	N, TNC, SMA, F, BNC, 7/16, UHF		
Grounding	M6 Screw, Bulkhead, Bracket		
Environmental Rating	IP65		
Operating Temperature	-40°C to +85°C		
Operating Altitude	4,000 m		
Relative Humidity	Up to 5 to 95% non-condensing, up to 100%		

<sup>1</sup> Maximum frequency type F : 2GHz

<sup>2</sup> Impedance for F type connector is 75 ohms

## Material

Component	Body	Male Contacts	Female Contacts	Insulators
Material	Brass	Bronze	Bronze	PTFE
Surface Plating	Cu Zn Sn	Gold/Silver	Gold/Silver	N/A



# Coaxial Surge Protectors - 6GHz

## P8AX-6G Series



P8AX09-6G-N/MF

- **6GHz Bi-Directional Coaxial Surge Protector**
- **Low Insertion Loss**
- **High Energy GDT Technology**
- **Field Replaceable GDT**
- **Waterproof Design**
- **DC Pass Configuration**
- **Bi-Directional Protection**

P8AX-6G-

Type : MF = Male/Female  
FF = Female/Female

Connectors (see reference system page 112)

Voltage (see reference system page 112)

### Dimensions

(in mm)

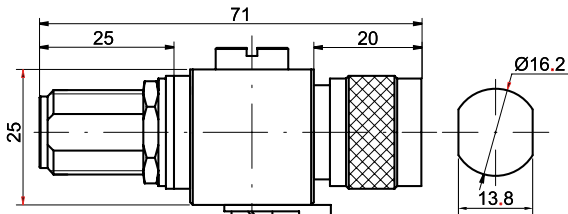

Dimensions vary by connector, N connector shown

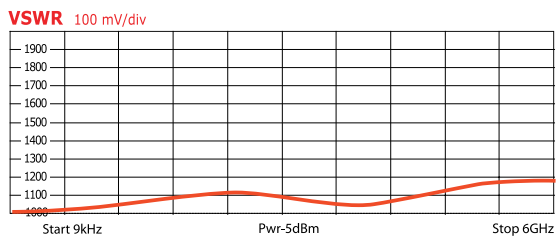
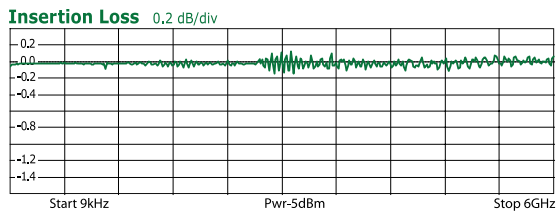

### Characteristics

CITEL Part Number	P8AX09-6G	P8AX25-6G
Frequency	DC-6GHz	DC-6GHz
Technology	Gas discharge tube	Gas discharge tube
Insertion Loss	<0.2db	<0.2db
Return Loss	>19 db	>19 db
VSWR	<1.25:1	<1.25:1
Discharge Current (8/20 µs)	20 kA	20 kA
Protection Level	< 700 V	< 700 V
Maximum Power	70 W	240 W
Maximum Current	10 A	10 A
Impedance	50 ohms	50 ohms
Connection Method	Series (bi-directional)	
<b>Mechanical Characteristics</b>		
Connectors	N, TNC, SMA	
Grounding	M6 Screw, Bulkhead, Bracket	
Environmental Rating	IP65	
Operating Temperature	-40°C to +85°C	
Operating Altitude	4,000m	
Relative Humidity	Up to 5 to 95% non-condensing, up to 100%	

### Material

Component	Body	Male Contacts	Female Contacts	Insulators
Material	Brass	Bronze	Bronze	PTFE
Surface Plating	Cu Zn Sn	Gold/Silver	Gold/Silver	N/A